



EUROPEAN YACHTING NETWORK

Stevens Nautical Nautical 68 (2012)

Property: 12.003.811



EYN Price: from **€ 1.500.000**

Casco price: from € 153.500 (Delivery time casco: 9 months)

Price Technically ready to sail: from € 255.000 (Delivery technical ready to sail: 12 months)

Complete price: from € 1.500.000 (Delivery complete: 15 months)

Length: 22,00 m; Width: 5,35 m; Draft: 1,60 m; Headroom: 0,00 m; Engine brand: Perkins M225Ti;
Total engine power: 450 hp; Engine hours: Unknown; Number of engines: 2 ; Trade: Negotiable

From the famous quality yacht builder Stevens Nautical we offer you this luxury Nautical 68. The yacht can be entirely adapted to your wishes. Please contact us for further information.



EUROPEAN YACHTING NETWORK

The yacht

Brand :	Stevens Nautical
Type :	Nautical 68
Boat type :	Motor yacht
BTW/VAT :	Not paid
Year of construction :	2012
Berth :	Noord- Brabant - Nederland
Shipyard :	Stevens Nautical
Designer :	Stevens Nautical

Sizes & Weights

Length :	22,00 m
Width :	5,35 m
Draft :	1,60 m
Clearance :	5,10 m
Drinking water :	1.500 l
Black water :	1.000 l

The engine

Engine brand :	Perkins M225Ti
Total engine power :	450 hp
Last service :	-
Fuel tank capacity :	3.000 l



EUROPEAN YACHTING NETWORK

* POSSIBILITIES

Suitable for habitation :	Yes
Trade :	Negotiable

DECK EQUIPMENT

Anchor :	Hydraulic Broes hggp RVS 45 Kg.
Options present :	Rail Sailing lights Deck washing system Self-draining cockpit Swimming platform Swimming ladder

ELECTRONICS

Heating :	Kabola CV / Boiler systeem
Voltage circuit :	24v + 220v
Options present :	Battery charger Shore power

ENGINE ROOM

Number of engines :	2
Generator :	Kohler 17 EFOZD, 13 Kw / 20 kVA
Fuel :	Diesel
Type of starting batteries :	maintenance free
Starting batteries :	4 x 200 Amp
Type of light batteries :	maintenance free
Light batteries :	6 x 200 Amp
Options present :	220V socket Converter Mastervolt adapted to system used Water pressure system Boiler Kabola Ventilation

ENTERTAINMENT

Options present :	TV Sound system
--------------------------	--------------------

GALLEY



EUROPEAN YACHTING NETWORK

Cooking ring :	5 burners
Options present :	Sink Fridge Coolmatic 150 liter

INTERIOR LAYOUT

Window frames :	Aluminium with condens gutters
Bedrooms :	4
Berths :	8
Bathroom :	4
Options present :	Aft cabin Dinette

MATERIALS INTERIOR

Floor covering :	Carpet
Woodwork :	Mahogany
Ceiling :	Skai
Seats :	Fabric or by choice

NAVIGATION

Bow thruster :	Hydraulic
Heck thruster :	Option
Options present :	Log Depth gauge Claxon

OTHER

Options present :	Fenders
--------------------------	---------

SAFETY

CE-mark :	B
Options present :	Sprinkler system

TECHNICAL DETAILS

Technical condition below the waterline :	Good condition The entire ship is with a 2-component epoxy based primer preserved. Primed with epoxy filler and painted with a high quality finish,
--	---



EUROPEAN YACHTING NETWORK

	application manually with roller and brush (traditional).
Type of engine :	Inboard
Propulsion :	Fixed propeller shaft
Material (hull) :	Welded steel 5/6/8mm A grade steel, two component coating. Frames every 40 cm in context.
Type of boat :	Yacht
Type of hull :	Multi chine
Sailing properties :	Displacement
Steering equipment :	Hydraulic
Material structure :	Steel 5/6/8mm grade A steel, 2-component paint
Technical condition hull :	Good condition
Technical condition deck :	Good condition
Condition structure :	Good condition
Options present :	Stabilizers Air-conditioning Second Steering console

WET ROOM

Bathrooms :	4
Shower :	4
Toilet :	4



EUROPEAN YACHTING NETWORK

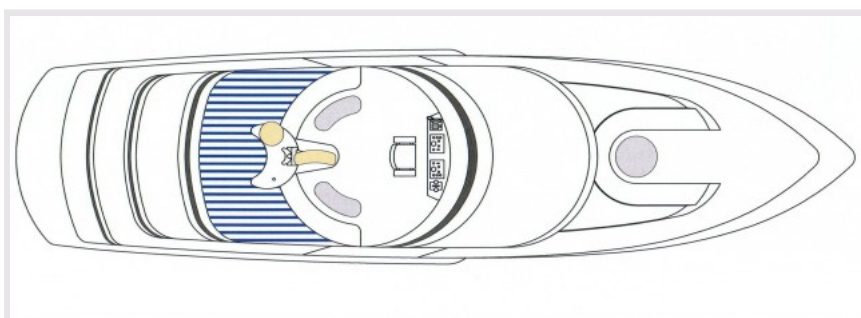
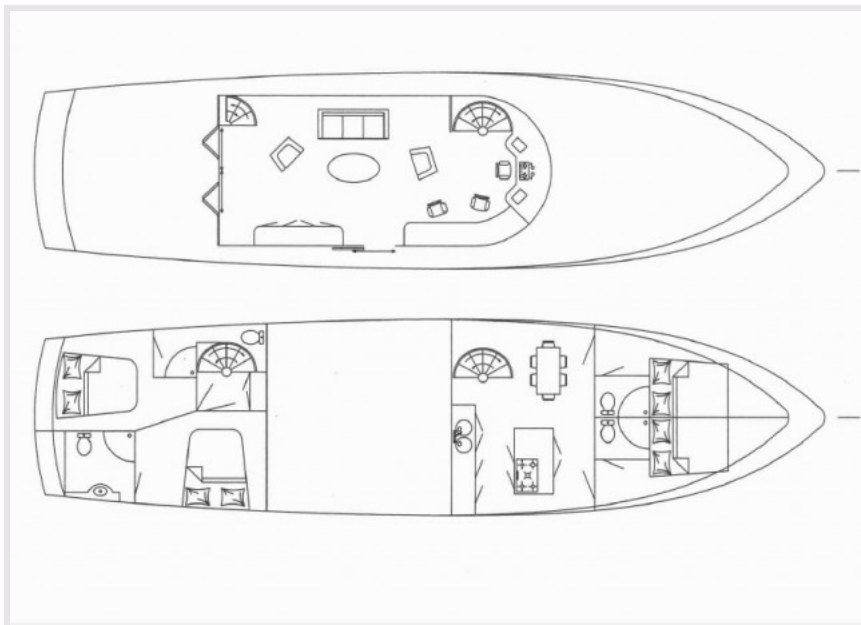



EUROPEAN YACHTING NETWORK

From the famous Dutch quality shipbuilder Stevens Nautical we offer you this Nautical 68.

The ship can be entirely adapted and arranged to your wishes.

Contact the E-Y-N yacht broker in your region for further information.

Van de beroemde Nederlandse kwaliteits scheepsbouwer Stevens Nautical bieden wij u deze Nautical 68 aan.

Het schip kan volledig aan uw wensen worden aangepast en ingericht worden.

Contacteer de het jachtmakelaar van E-Y-N in uw gebied voor meer informatie.



EUROPEAN YACHTING NETWORK

Vom berühmten holländischen Qualitätsschiffbauer Stevens Nautical bieten wir Ihnen dieses Nautical 68 an.

Das Schiff kann zu Ihren Wünschen völlig angepasst und geordnet werden.

Treten Sie mit dem Yachtvermittler e-Y-N in Ihrer Region für weitere Informationen in Verbindung.

