



EUROPEAN YACHTING NETWORK

## Stevens Nautical Nautical 68 (2012)

Property: 12.003.811



EYN Price: from **€ 1.500.000**

Casco price: from € 153.500 (Delivery time casco: 9 months)

Price Technically ready to sail: from € 255.000 (Delivery technical ready to sail: 12 months)

Complete price: from € 1.500.000 (Delivery complete: 15 months)

Length: 22,00 m; Width: 5,35 m; Draft: 1,60 m; Headroom: 0,00 m; Engine brand: Perkins M225Ti;  
Total engine power: 450 hp; Engine hours: Unknown; Number of engines: 2 ; Trade: Negotiable

From the famous quality yacht builder Stevens Nautical we offer you this luxury Nautical 68. The yacht can be entirely adapted to your wishes. Please contact us for further information.



EUROPEAN YACHTING NETWORK

### The yacht

<b>Brand :</b>	Stevens Nautical
<b>Type :</b>	Nautical 68
<b>Boat type :</b>	Motor yacht
<b>BTW/VAT :</b>	Not paid
<b>Year of construction :</b>	2012
<b>Berth :</b>	Noord- Brabant - Nederland
<b>Shipyard :</b>	Stevens Nautical
<b>Designer :</b>	Stevens Nautical

### Sizes & Weights

<b>Length :</b>	22,00 m
<b>Width :</b>	5,35 m
<b>Draft :</b>	1,60 m
<b>Clearance :</b>	5,10 m
<b>Drinking water :</b>	1.500 l
<b>Black water :</b>	1.000 l

### The engine

<b>Engine brand :</b>	Perkins M225Ti
<b>Total engine power :</b>	450 hp
<b>Last service :</b>	-
<b>Fuel tank capacity :</b>	3.000 l



## EUROPEAN YACHTING NETWORK

### \* POSSIBILITIES

<b>Suitable for habitation :</b>	Yes
<b>Trade :</b>	Negotiable

### DECK EQUIPMENT

<b>Anchor :</b>	Hydraulic Broes hggp RVS 45 Kg.
<b>Options present :</b>	Rail Sailing lights Deck washing system Self-draining cockpit Swimming platform Swimming ladder

### ELECTRONICS

<b>Heating :</b>	Kabola CV / Boiler systeem
<b>Voltage circuit :</b>	24v + 220v
<b>Options present :</b>	Battery charger Shore power

### ENGINE ROOM

<b>Number of engines :</b>	2
<b>Generator :</b>	Kohler 17 EFOZD, 13 Kw / 20 kVA
<b>Fuel :</b>	Diesel
<b>Type of starting batteries :</b>	maintenance free
<b>Starting batteries :</b>	4 x 200 Amp
<b>Type of light batteries :</b>	maintenance free
<b>Light batteries :</b>	6 x 200 Amp
<b>Options present :</b>	220V socket Converter Mastervolt adapted to system used Water pressure system Boiler Kabola Ventilation

### ENTERTAINMENT

<b>Options present :</b>	TV Sound system
--------------------------	--------------------

### GALLEY



## EUROPEAN YACHTING NETWORK

<b>Cooking ring :</b>	5 burners
<b>Options present :</b>	Sink Fridge Coolmatic 150 liter

### INTERIOR LAYOUT

<b>Window frames :</b>	Aluminium with condens gutters
<b>Bedrooms :</b>	4
<b>Berths :</b>	8
<b>Bathroom :</b>	4
<b>Options present :</b>	Aft cabin Dinette

### MATERIALS INTERIOR

<b>Floor covering :</b>	Carpet
<b>Woodwork :</b>	Mahogany
<b>Ceiling :</b>	Skai
<b>Seats :</b>	Fabric or by choice

### NAVIGATION

<b>Bow thruster :</b>	Hydraulic
<b>Heck thruster :</b>	Option
<b>Options present :</b>	Log Depth gauge Claxon

### OTHER

<b>Options present :</b>	Fenders
--------------------------	---------

### SAFETY

<b>CE-mark :</b>	B
<b>Options present :</b>	Sprinkler system

### TECHNICAL DETAILS

<b>Technical condition below the waterline :</b>	Good condition The entire ship is with a 2-component epoxy based primer preserved. Primed with epoxy filler and painted with a high quality finish,
--	---



## EUROPEAN YACHTING NETWORK

	application manually with roller and brush (traditional).
<b>Type of engine :</b>	Inboard
<b>Propulsion :</b>	Fixed propeller shaft
<b>Material (hull) :</b>	Welded steel 5/6/8mm A grade steel, two component coating. Frames every 40 cm in context.
<b>Type of boat :</b>	Yacht
<b>Type of hull :</b>	Multi chine
<b>Sailing properties :</b>	Displacement
<b>Steering equipment :</b>	Hydraulic
<b>Material structure :</b>	Steel 5/6/8mm grade A steel, 2-component paint
<b>Technical condition hull :</b>	Good condition
<b>Technical condition deck :</b>	Good condition
<b>Condition structure :</b>	Good condition
<b>Options present :</b>	Stabilizers Air-conditioning Second Steering console

### WET ROOM

<b>Bathrooms :</b>	4
<b>Shower :</b>	4
<b>Toilet :</b>	4



EUROPEAN YACHTING NETWORK

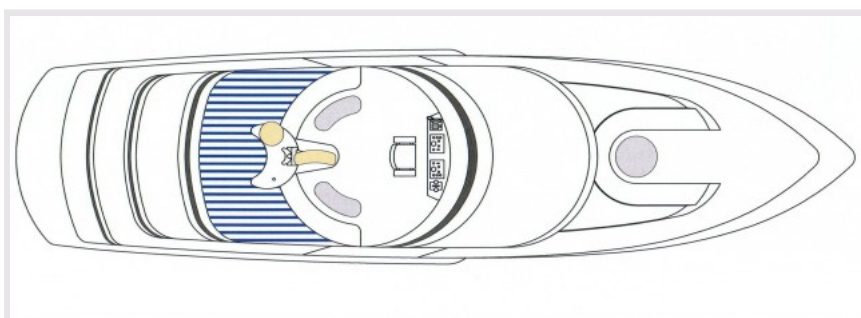
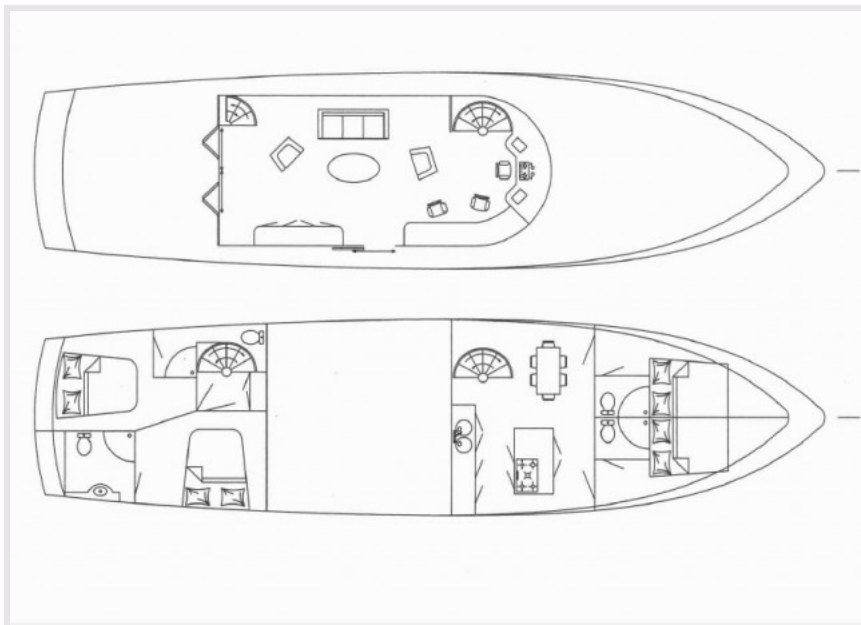



EUROPEAN YACHTING NETWORK

From the famous Dutch quality shipbuilder Stevens Nautical we offer you this Nautical 68.

The ship can be entirely adapted and arranged to your wishes.

Contact the E-Y-N yacht broker in your region for further information.

Van de beroemde Nederlandse kwaliteits scheepsbouwer Stevens Nautical bieden wij u deze Nautical 68 aan.

Het schip kan volledig aan uw wensen worden aangepast en ingericht worden.

Contacteer de het jachtmakelaar van E-Y-N in uw gebied voor meer informatie.



EUROPEAN YACHTING NETWORK

Vom berühmten holländischen Qualitätsschiffbauer Stevens Nautical bieten wir Ihnen dieses Nautical 68 an.

Das Schiff kann zu Ihren Wünschen völlig angepasst und geordnet werden.

Treten Sie mit dem Yachtvermittler e-Y-N in Ihrer Region für weitere Informationen in Verbindung.

